

# AÉROWING GATE

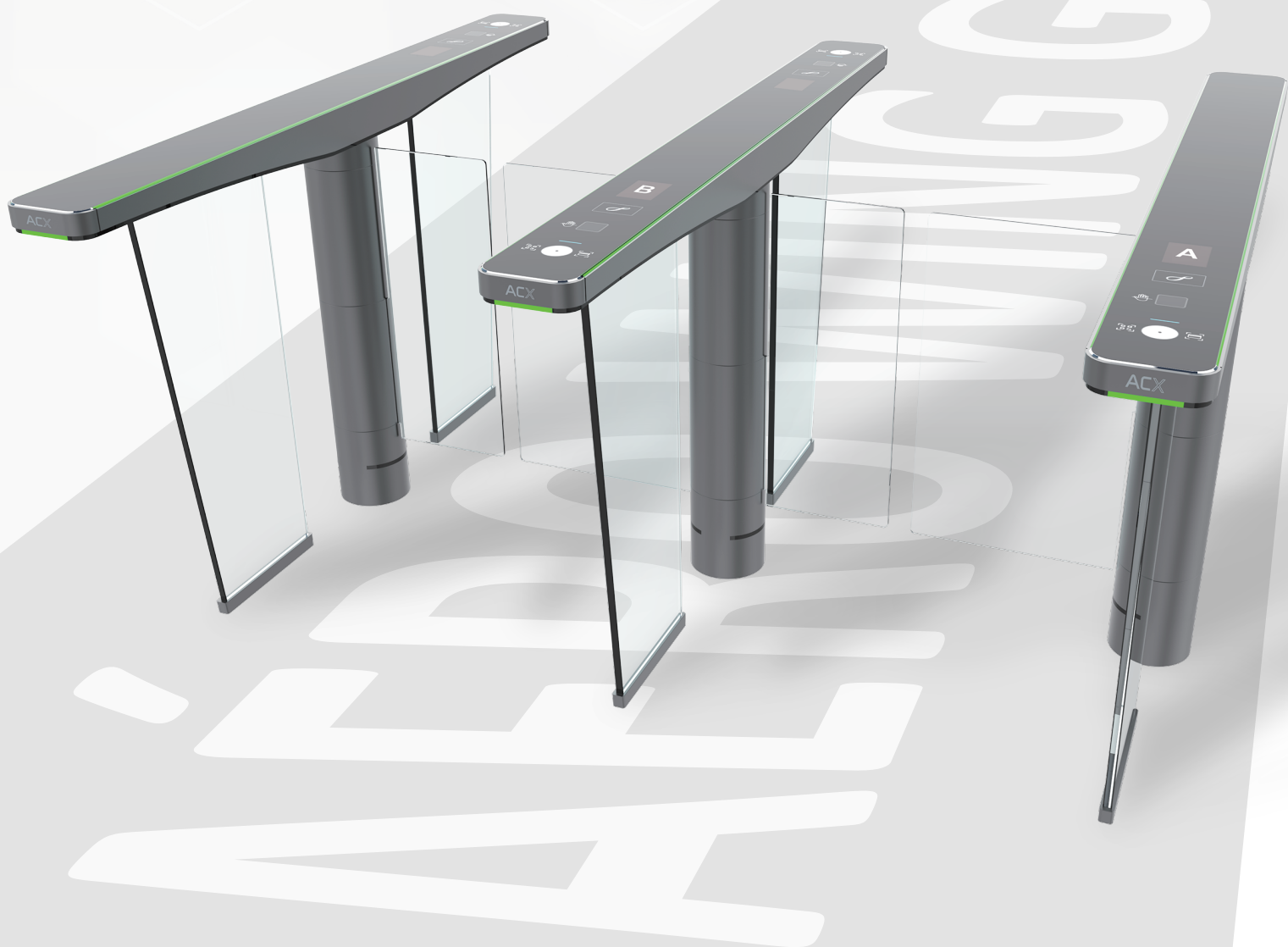

# PRODUCT INTRODUCTION

The simplicity of the T1 AéroWing Gate naturally blends the turnstile into sophisticated surroundings. The vibrant LED lights are meticulously positioned along the edges of the top, guiding visitors to authorized areas. Advanced verification technologies such as Facial Recognition, Palm Vein, QR Code are intelligently integrated with the speed gate, offering not only a peace of mind but also an aesthetic yet secure solution to any buildings and businesses.



Its lightweight, almost airy T-shaped design encapsulates perfectly the unique beauty of pureness. This effortless simplicity harmonizes the speed gate with any entrances, constructing a pleasant and an unparalleled authentication experience.

## SCOPE OF APPLICATION

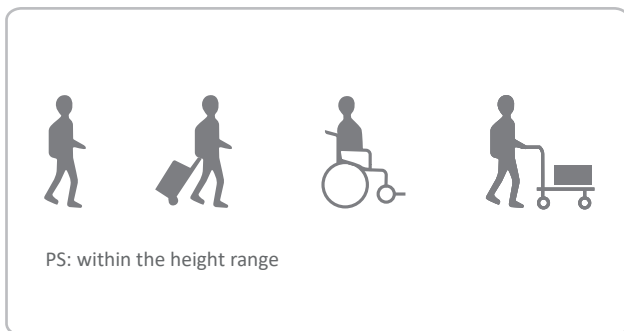

## SUPPORT

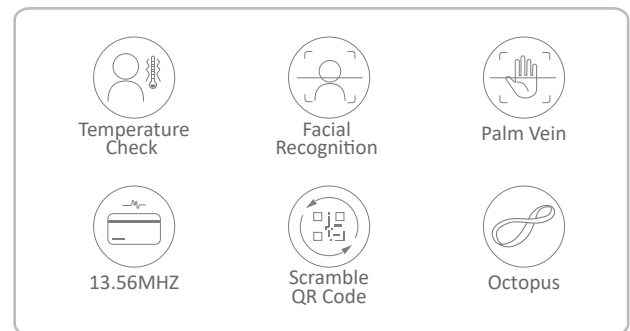

# FUNCTIONAL FEATURES



Control mode:  
9 kinds of dual-direction control mode (alternative)



Remote control and configuration, user interface personalization



Operational mode:  
Normal open / closed position (alternative)



Real-time status monitoring with 8 pairs of OMRON sensors (standard)



Passage Memory:  
Support 0 to 99 consecutive door opening signal input



Operating speed  
0.8s-1.6s (customizable)



LED lights indication:  
Status indication / Direction indication



Laser sensor:  
Higher detection accuracy compared with IR



Standard external electrical interface, with photoelectric safety isolation



Advanced protection to prevent electrical leakage, pinching, and collision



2D laser module:  
Ground-level safety sensor for child-friendly passage



Enhanced anti-tailgating design

# BASIC SPECIFICATIONS

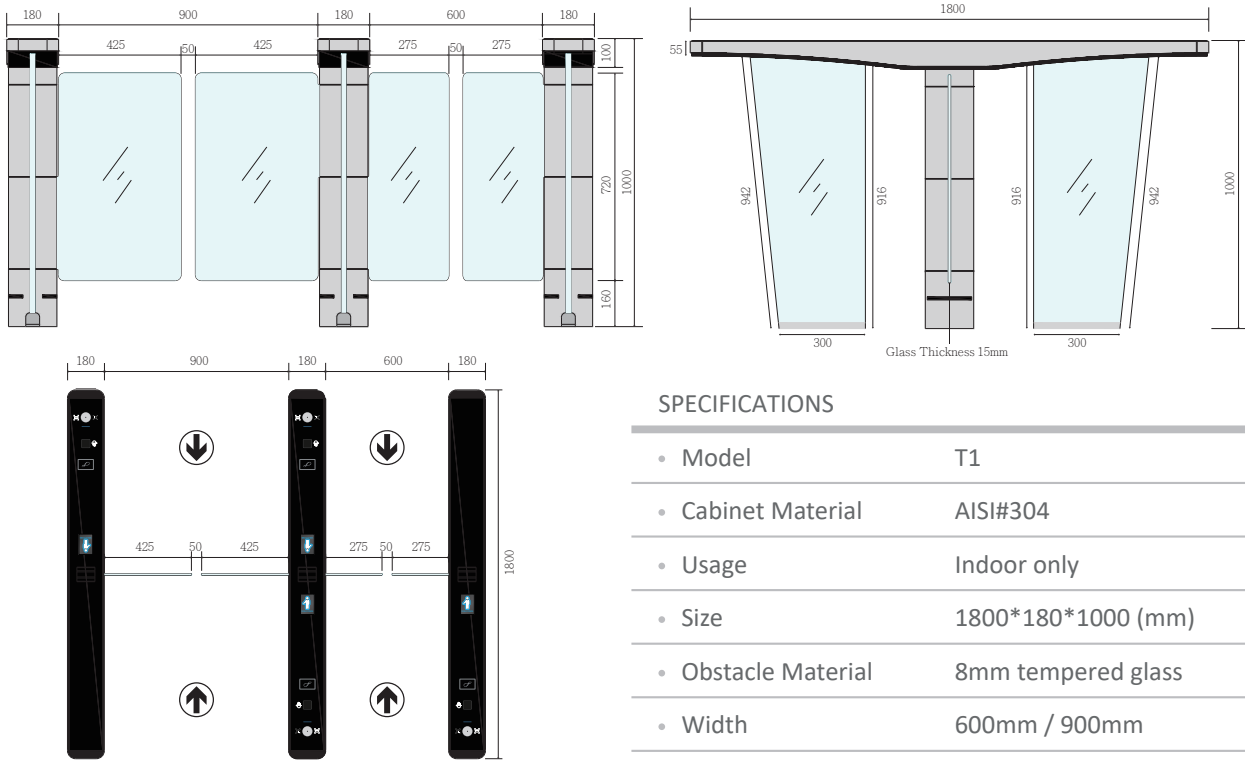

## SPECIFICATIONS

|                     |                    |
|---------------------|--------------------|
| • Model             | T1                 |
| • Cabinet Material  | AISI#304           |
| • Usage             | Indoor only        |
| • Size              | 1800*180*1000 (mm) |
| • Obstacle Material | 8mm tempered glass |
| • Width             | 600mm / 900mm      |

# MECHANICAL PERFORMANCE

- Door Positioning: Servo-controlled moving position encoder
- Door Opening: 90° to the middle
- Low Noise Operation: ≤ 60db
- Fail Safe Operation: Lock disengages in case of power outage
- Movement Angle: 166°
- Capacity: ≥ 25 people/minute
- Power Drive: DC24V
- Lifespan: ≥ 15M times
- MCBF: ≥ 30M times

## CUSTOMIZABLE OPTIONS

- Material: SUS#316 or others
- Appearance: Colour Spray or Electroplating (colour board provided by clients)
- Gate Length: Customizable based on clients' requirements
- Surface: Wiredrawing (standard) / Glossy / Matte
- Obstacle: Length / Height / Printed pattern
- Card Area: Customized printed pattern
- Others: Customized to support other forms of biometric authentication
- Installation: Customized flooring panels (floor slotting not required)

## ELECTRICAL & ENVIRONMENTAL

- Supply Voltage: AC110V ± 10% 60Hz (Optional); AC220V ± 10% 50Hz
- Frequency: Single-phase 50Hz to 60Hz
- Working Voltage: DC24V
- Current: Static 300mA; dynamic 3A (maximum operating current)
- Operating Temperature: 0 to 60°C (32 to 140°F)
- Storage Temperature: -20 to 60°C (-4 to 140°F)
- Relative Humidity: 5% to 95% (non-condensing)

## 2D TURNSTILE LASER MODULE

- Laser Wavelength: 905nm (non-visible light)
- Laser Safety Class: Class 1 (IEC 60825-1:2014), safe for human eyes
- Operating Frequency: 10Hz
- Distance Resolution: ± 2cm
- Response Time: ≤ 100ms
- Accuracy: 99% (unobstructed)
- Operating Temperature: -20°C to +60°C